

Insulation

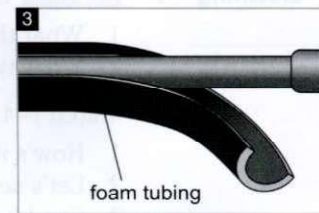
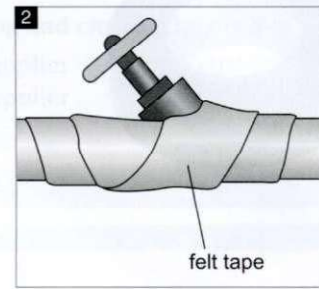
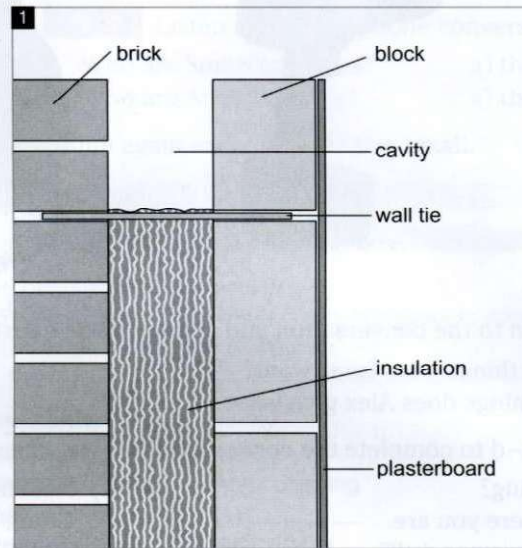

Listening 1 25 Listen to and read the beginning of a conversation between a client and a building contractor and choose the correct answer.

- 1 Which speaker is the client? (A / B)
- 2 Which speaker is the building contractor? (A / B)

A: Can you tell me about wall insulation?

B: Sure. There are two types of wall insulation: cavity and solid. Both types provide thermal and acoustic insulation.

A: What's the difference?

B: Let me explain. Sometimes walls are solid, so the insulation is on the outside of the wall. This is solid wall insulation.

2 26 Read the rest of the conversation and put it in the correct order. Then listen and check your answers.

- Yes, exactly.
- Sometimes walls have two parts: an inner wall and an outer wall. Cavity wall insulation means that the insulation material is inside the wall.
- 1 And cavity wall insulation?
- Ah, OK. So solid wall is outside and cavity wall is inside?
- I see. Thank you.
- What about pipes?
- OK, I understand. And what types of insulation do you use for cavity wall insulation?
- Our company uses three types of cavity wall insulation to fill the gap: foam, mineral wool, or polystyrene beads.
- For pipes, we normally use felt tape or foam tubing.

3 Are these statements *true* (T) or *false* (F)? Correct the false statements.

- 1 Solid wall insulation is used to provide thermal insulation. (T / F)
- 2 Felt tape is used as cavity wall insulation. (T / F)
- 3 Cavity wall insulation goes between the inner and outer walls. (T / F)
- 4 Foam tubing is used to insulate pipes. (T / F)
- 5 Polystyrene beads are used to insulate pipes. (T / F)

Language

Used to/Used as/Used for

Used to is followed by a verb.	<i>Solid wall insulation is used to provide thermal insulation.</i>
Used as/used for is followed by a noun or adjective + noun.	<i>Polystyrene beads are used as cavity wall insulation. Felt tape is used for pipes.</i>

4 Complete these sentences with *to*, *as* or *for*.

- 1 Foam tubing is used _____ insulate pipes.
- 2 Foam tubing is used _____ pipe insulation.
- 3 Plasterboard is used _____ cover the inner wall.
- 4 Wall ties are used _____ hold the inner and outer walls together.
- 5 Polystyrene beads are used _____ cavity wall insulation.

5 Look at the illustrations on page 32. Listen again to recording 26 in 2 and answer these questions.

- 1 Look at illustration 1. Is it solid wall insulation or cavity wall insulation? _____
- 2 What three materials are used in cavity wall insulation? _____, _____ or _____
- 3 What two types of insulation are used for pipes? _____ or _____
- 4 Which word in the conversation means *cavity*? _____

Speaking 6 Work in pairs and have two telephone conversations. Student A look at the information on this page. Student B look at the information on page 69.

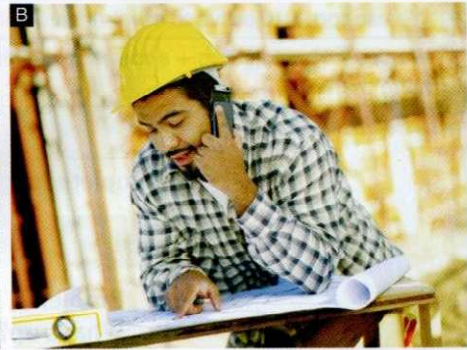

Student A

- 1 You work for a supplier. Here is an extract of your email to a customer. Phone the customer and tell him/her that Supamat 56 is out of stock. Delivery is next week. Supamat 87 is in stock. You can deliver tomorrow.

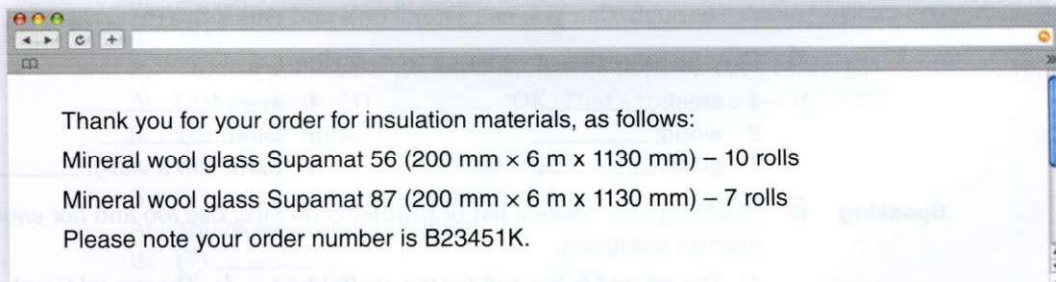

- 2 There is a problem with the customer's order. Answer his/her call.